

SHEET 2 of 6 SHEETS

S.G. No. D 655/2007

AMENDING SECTIONAL PLAN OF EXTENTION  
OF SCHEME  
(and affects Sectional Plan  
S.G. No. D321/2004 and SS. 598/2004 )

APPROVED  
*Abdoyun 12-9-2007*  
for SURVEYOR-GENERAL Date

MAIN FIGURE DATA

SIDES	METRES	DIRECTIONS
AB	25,00	247.22.50
BC	10,00	338.16.20
CD	22,36	274.49.50
DE	34,99	325.48.10
EF	112,28	284.12.50
FG	188,12	32.31.50
GH	67,76	88.55.20
HJ	23,08	166.30.10
JK	45,00	76.30.10
KL	16,53	166.30.10
LM	87,86	158.00.30
MN	17,72	202.49.30
NP	69,31	247.22.50
PQ	5,00	338.00.30
QR	30,15	247.22.50
RA	63,01	158.16.20

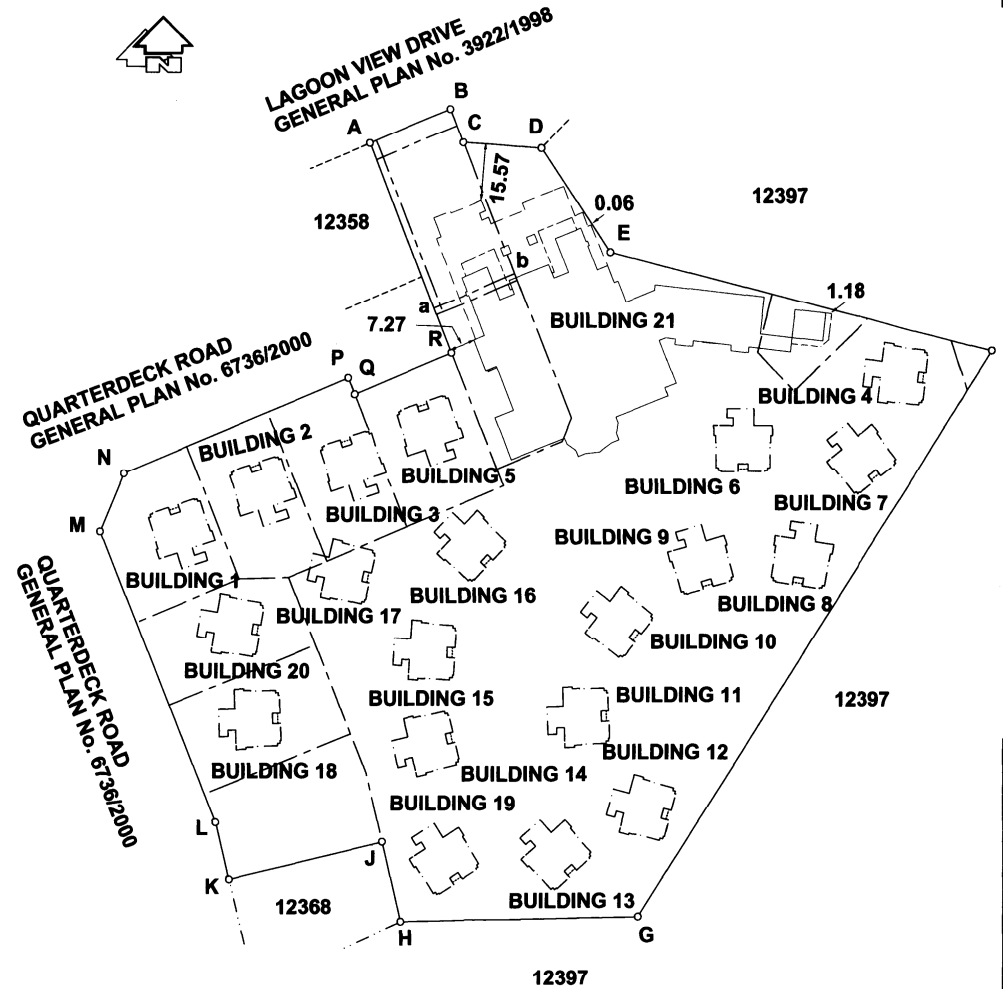

NOTES

1. The figure ABCDEFGHJKLMNPQR represents Erf 13065 Knysna
2. The line Aa represents the southwestern boundary of a pipeline servitude 2,00m wide, vide G.P. No. 6736/2000
3. The line ab represents the southeastern boundary of an electrical servitude 2,00m wide, vide G.P. No. 6736/2000
4. The line AB represents the northwestern boundary of a garden servitude 5,00m wide, vide G.P. No. 6736/2000
5. ——— denotes Consolidation Component Line
6. - - - - - denotes projections above ground floor beyond external surfaces of buildings at ground level.
7. Land Data obtained from SRE 2887/2000 and 2449/2001
8. - - - - - denotes Previous Phase.
9. - - - - - denotes projections below ground floor beyond external surfaces of building at ground level.

LAND SURVEYOR R.J. KOHLER  
P.O.Box 173  
Knysna  
6570  
Signed: *[Signature]*  
Date : 02 July 2007

PEZULA HOTEL  
DRAWING TITLE :  
BLOCK PLAN  
  
SCALE 1:1500